



Installation Tips

ALWAYS lay out the material to let it relax back into its original shape; this is a good time to double-check molding style and application.

NEVER pre-finish the material prior to installation. The material may flex during installation and cause fractures in the finish.

ALWAYS make certain that the surface you are applying the material to is flat and smooth. Flexible molding will follow any irregularities in the surface.

NEVER use staples or nails with large heads. Keep nails to a minimum and away from edges to avoid "bumps" at the edge.

ALWAYS use a construction adhesive in conjunction (E-6100) with or in lieu of nails. This will ensure a quick and easy application and a cleaner finished look.



Cutting

- Flex Trim moldings can be cut, sanded and shaped using typical woodworking tools.
- Cut material long and then shave to exact length.
- Do not sand wood grain on stain grade material.



Fastening

- Pre-determine material placement and layout.
- Use E-6100 adhesive.
- Keep nails to a minimum.
- Keep nails away from edges to prevent "bumps" at edges.

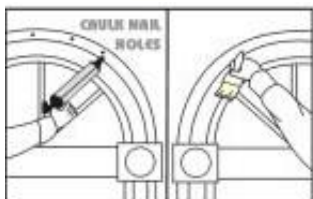

Painting

- Clean material before painting.
- A primer coat is recommended but not required.
- Never paint before installation. The material is flexible and the paint may crack during installation.
- All paints work well.

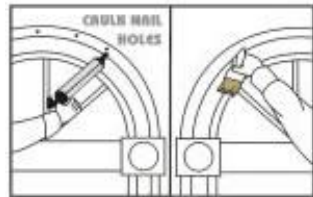

Staining

- Never stain before installation.
- Clean material thoroughly before staining.
- Heavy stains such as "gelled stains" work best.
- Clear coat after staining.